



ROCKLER®

CREATE WITH CONFIDENCE

SL Router Lift Instructions

Effective March 2024



Review full instructions prior to use for important safety information.
Always check Rockler.com to confirm that you are using the most recent version of instructions for your product.

GENERAL SAFETY WARNINGS

This product is designed only for specific applications as defined in the instructions and should not be modified or used for any manner not described in these instructions. Use only recommended accessories. Before using the SL Router Lift: **READ, UNDERSTAND** and **FOLLOW ALL INSTRUCTIONS AND SAFETY WARNINGS. KEEP THESE INSTRUCTIONS READILY AVAILABLE FOR FUTURE REFERENCE.**

- > Always confirm that you are using the most recent version of the instructions and safety warnings for your product (see the instructions link on the product page at Rockler.com).
- > Before using another tool with this product, always read, understand and follow the instructions and safety warnings in the owner's manual for that tool. If you do not have the owner's manual, obtain one from the tool's manufacturer before using it with this product.
- > Before using any chemical with this product, always read, understand and follow all safety warnings and guidelines in the manufacturer's Safety Data Sheet (SDS; formerly called "MSDS"), especially regarding:
 - How to safely use the chemical, including potential hazards and recommended first aid measures;
 - Personal safety equipment required to safely use the chemical (e.g. gloves, eye protection, mask/respirator, etc.);
 - Proper and safe handling, storage and disposal of the chemical.
- > Before using this product, review and verify that all tools to be used with it have safety equipment installed and are in proper working order as defined by the tool's owner's manual.
- > Do not use this product until you have read and are confident you understand:
 - Product Specific Safety Warnings (p. 3);
 - IMPORTANT - Does your router need an adapter? (p. 4);
 - Level the Insert Ring (pp. 4 - 5);
 - Mount Your Router (pp. 5 - 6);
 - Installing/Changing Router Bits (pp. 6 - 7);
 - Re-adjusting the Thread Tensioning (p. 7)
 - Using the Starter Pin (p. 8).
- > The user assumes all risk and responsibility for the proper and safe use of this product and for ensuring product suitability for the intended application.
- > It is the sole responsibility of the purchaser of this product to ensure that anyone you allow to use this product reads and complies with all instructions and safety precautions outlined in this manual prior to use.
- > Follow all standard shop safety practices, including:
 - Keep children and bystanders away from the tool operating area;
 - Do **NOT** use power tools in explosive environments, or in the presence of flammable liquids, fumes or dust;
 - **TURN OFF AND UNPLUG** all power tools **BEFORE** making any adjustments or changing accessories;
 - Remain alert and use good judgment. Do not use this product if you are in any way impaired by medications, alcohol, drugs or fatigue;
 - Keep your work area well lit and clean;
 - Dress appropriately. Secure loose clothing, remove all jewelry and tie up long hair before using this product;
 - **ALWAYS** wear safety glasses, hearing protection and respiratory protection that complies with NIOSH/OSHA/ANSI safety standards;
 - Use dust collection tools and dust face masks to reduce exposure to dust;
 - Use safety equipment such as featherboards, push sticks and push blocks, etc., when appropriate;
 - Maintain proper footing at all times and do not overreach;
 - Do **NOT** force woodworking tools.
- > These warnings and instructions do **NOT** represent the total of all information available regarding tool safety, use and technique. Always seek out opportunities to learn more and improve your skills and knowledge.

⚠ WARNING: Drilling, sawing, sanding or machining wood products can expose you to wood dust, a substance known to the State of California to cause cancer. Avoid inhaling wood dust or use a dust mask or other safeguards for personal protection. For more information go to www.P65Warnings.ca.gov/wood.

⚠ DANGER

Danger indicates a hazardous situation that, if not avoided, will result in death or serious injury.

⚠ WARNING

Warning indicates a hazardous situation that, if not avoided, could result in death or serious injury.

⚠ CAUTION

Caution indicates a hazardous situation that, if not avoided, may result in minor or moderate injury or property damage.

NOTICE

Notice indicates important or helpful information and/or user tips.

PRODUCT SPECIFIC SAFETY WARNINGS



⚠ DANGER

- > To avoid serious injury, keep hands and fingers away from spinning router bit. Maintain awareness of the bit at all times.

⚠ WARNING

- > The Insert Ring **MUST** be perfectly flush with the SL Router Lift plate. If it is not, the workpiece could catch and dangerous kickback could occur.
- > The SL Router Lift is sized for routers with a 3½" diameter motor.
- > To avoid serious injury and damage to your router and the SL Router Lift, the router motor **MUST** be securely mounted in the Router Lift's housing.
- > Refer to your router's owner's manual for specific safe operating instructions.
- > Unplug your router motor before installing or removing it or adjusting the SL Router Lift router housing.
- > To avoid serious injury, never attempt to cut a workpiece without an Insert Ring installed.
- > If attempting to rout a workpiece without using the router table fence, always use the included Starter Pin to begin the cut. Failure to do so could result in dangerous workpiece kickback and serious injury.
- > Use the Starter Pin **ONLY** with bearing-guided router bits. Use with other bits could result in serious injury.

⚠ CAUTION

- > Do **NOT** use a cordless drill to raise and lower the lift carriage. The resulting friction will cause premature wear to the threads.

IMPORTANT - DOES YOUR ROUTER NEED AN ADAPTER?

The SL Router Lift is sized to accommodate midsize routers with 3½" diameter motors, such as the DeWalt 616, Bosch 1617 and Porter-Cable 690 and 890 series. However, Adapter Collars (sold separately) also are available to enable you to mount some of the most popular compact routers. See below to determine which one you need, and obtain the proper Adapter Collar before proceeding. **If your router requires an Adapter Collar, you will not be able to use the SL Router Lift without it.**

2.73" Adapter Collar (58234, sold separately):
Fits DeWalt DWP611, DCW600B and Porter-Cable 450 compact routers, as well as others with a router motor circumference of 8.58"

2.87" Adapter Collar (58753, sold separately):
Fits 1.25 HP Bosch Colt and 1 HP Bosch Colt compact routers, and others with a router motor circumference of 9.02"



Fig. 1

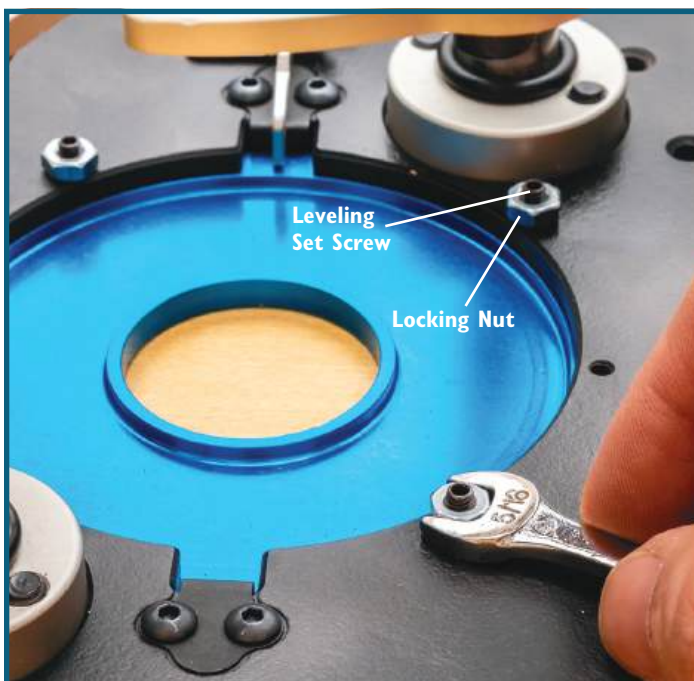

Fig. 2

Level the Insert Ring

NOTICE

The Insert Ring included with the SL Router Lift has a 1½" bit opening. Additional Insert Rings with other bit opening sizes are sold separately.

1. If the removable Insert Ring is not installed in the center of the SL Router Lift plate, press it firmly into the opening to snap it in.

⚠WARNING

The Insert Ring **MUST** be perfectly flush with the SL Router Lift plate. If it is not, the workpiece could catch and dangerous kickback could occur.

2. Use your finger or a flat piece of wood to determine whether the Insert Ring is flush with the plate. If it is not perfectly flush, you will need to adjust it. **Fig. 1.**
3. To make the adjustments, press the Snap-Lock button to remove the aluminum Insert Ring from the plate.
4. Set the SL Router Lift upside down on a smooth surface and loosen the nuts securing the leveling set screws.



Fig. 3

5. Use an M2 hex wrench (not included) to adjust the set screws as needed.
 6. Turn the lift upright. Snap the Insert Ring back into the opening and check to see whether it's flush with the plate.
 7. If it's not, repeat Steps 3-6 until it is. Then tighten the locking nuts on the set screws. **Fig. 2.**
 8. Press the Snap-Lock Insert Release Button to remove the aluminum Insert Ring from the plate for the rest of the assembly process.
2. Insert the crank handle in the dial on the lift's top plate. Turn the crank clockwise to raise the carriage so that it just contacts the O-rings at the top of the carriage shafts. The carriage should be all the way toward the plate. **Fig. 4.**
 3. Before installing the router motor, set the lift upside down on blocks of wood so the router's collet will be able to extend through the center hole in the top plate. **Fig. 4.**
 4. If necessary, loosen the two locking nuts on the lift's locking mechanism and loosen the socket-head adjustment screw with an M6 hex wrench (not included) to accept the router motor. **Fig. 5.**

Mount Your Router

⚠ WARNING

- > Unplug your router motor before installing or removing it or adjusting the SL Router Lift router housing.
- > To avoid serious injury and damage to your router and the SL Router Lift, the router motor **MUST** be securely mounted in the lift's housing. The bolts securing the motor in the housing should be checked and retightened, if necessary, with each use.

NOTICE

Do **NOT** align the gap in the Adapter Collar with the spreader gap in the SL Router Lift housing.

1. If you are installing the motor from a compact router, an Adapter Collar is required (see page 4 for details). Insert the Adapter Collar into the housing so that its lipped edge will rest on the SL Router Lift housing when the lift is in the upright position. If the Adapter Collar, doesn't fit at first, follow Step 4 to loosen the housing. **Fig. 3.**



Fig. 4

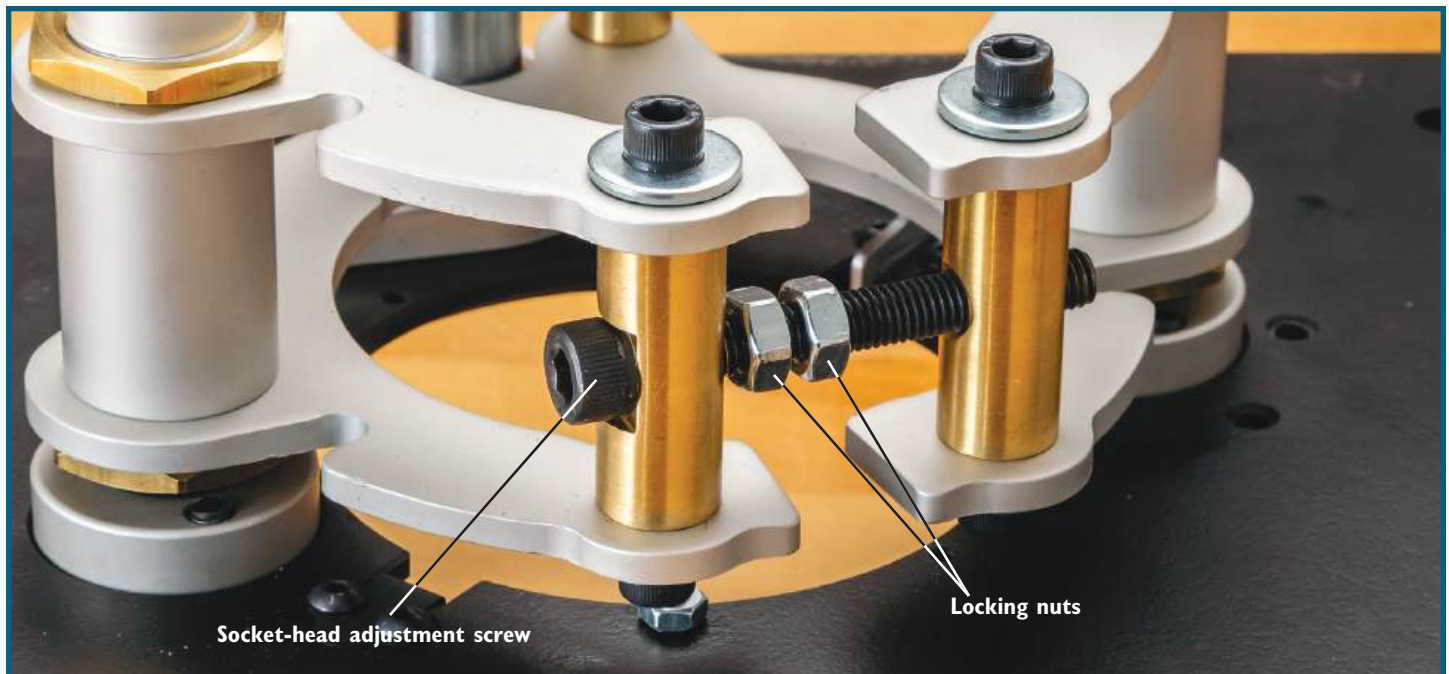

Fig. 5

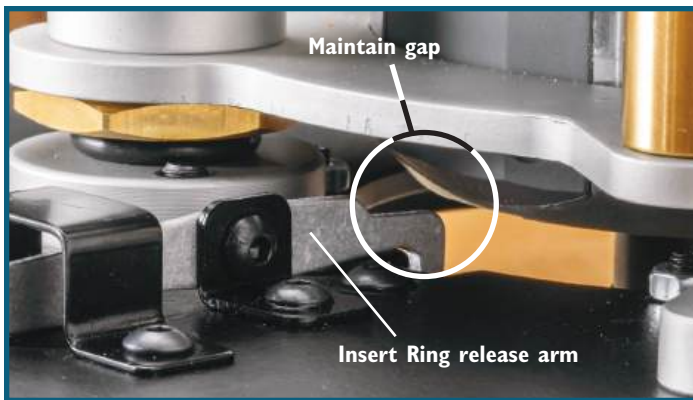

Fig. 6

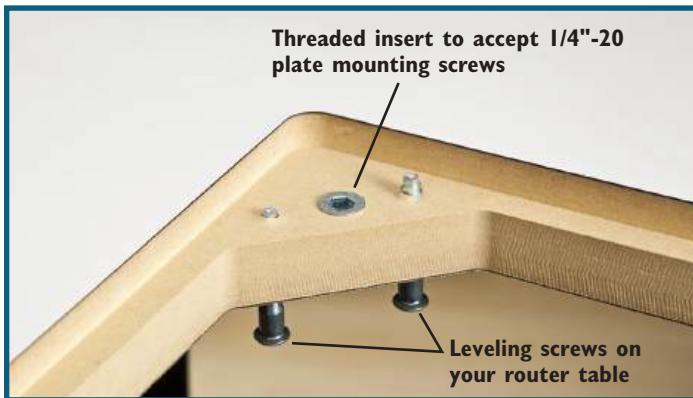

Fig. 7



Fig. 8

- Slide the motor into the lift carriage, stopping 1/8" before the motor contacts the Insert Ring release arm. **Fig. 6.** If your router has a height adjustment rack on the outside of the motor housing, be sure to orient the router so the rack fits in the opening in the carriage. If possible, rotate the motor so that the on/off switch and variable speed controls will be easily accessible to you when the lift is installed in your router table.
- Once your router is positioned in the carriage, make sure you've maintained the clearance between the motor housing and the Insert Ring release arm and tighten the socket-head adjustment screw until the router cannot shift or slide. Then tighten the locking nuts.

NOTICE

If you are installing the SL Router Lift in a custom table application, you will have to fabricate the correctly sized opening yourself. Rockler offers a separate template (20956, sold separately) to make this operation easier and more accurate.

- Fit the SL Router Lift in the center opening of your router table. It is sized to fit the 8 1/4" x 11 3/4" openings of Rockler and Bench Dog router tables. Use the leveling screws that came with your router table to bring the plate flush to the table on all edges. **Fig. 7.** Then secure the lift to the table by using the included M4 hex wrench to install the two included 1/4"-20 plate-mounting screws.

⚠ WARNING

To avoid serious injury, never attempt to cut a workpiece without an Insert Ring installed.

- Before use, snap the Insert Ring back into the plate's center opening.

Installing/Changing Router Bits

- Press the Snap-Lock Insert Release Button to pop the aluminum Snap-Lock Insert Ring off the plate.

⚠ CAUTION

Do **NOT** use a cordless drill to raise and lower the lift carriage. The resulting friction will cause premature wear to the threads.

- Insert the Crank Handle in the dial in the lift plate. Turn the crank clockwise to raise the carriage until the router collet is fully accessible. **Fig. 8.**
- Use the wrench(es) that came with your router to loosen the collet, if necessary, and insert the desired bit in the collet. Let it bottom out; then lift it 1/16" before tightening the collet. This is to help ensure the collet is gripping the full shank of the bit.

NOTICE

To "zero-out" the Fine-Adjustment dial, spin the thumbwheel until the "0" lines up with the engraved line on the plate. The socket must not turn during this step. **Fig. 9.**

- Use the crank handle to lower the bit, and then snap the Insert Ring back into place.
- When you've achieved the height desired, remove the handle and place it somewhere off the work surface for safety.



Fig. 9

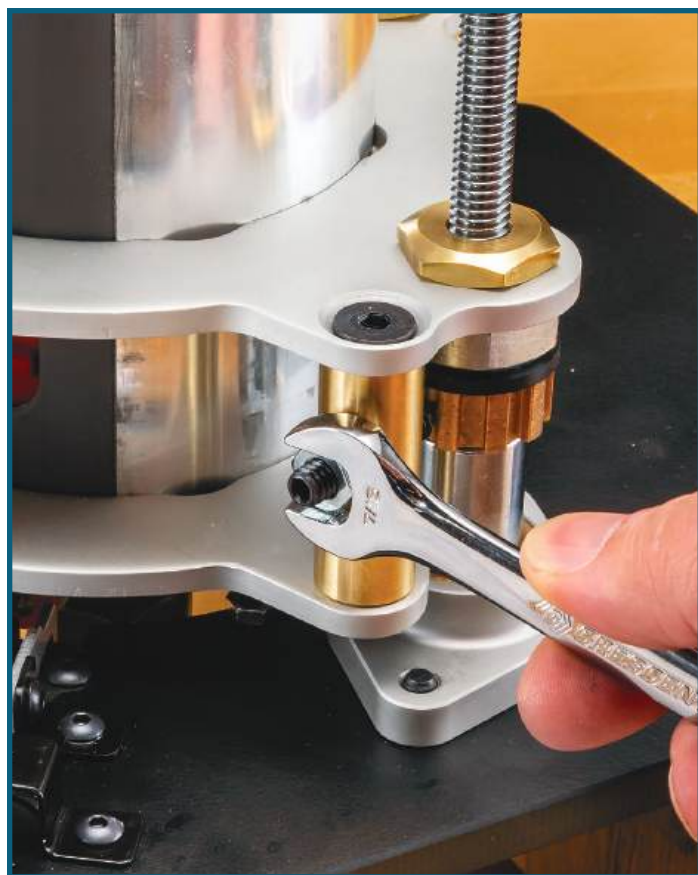

Fig. 10

Re-adjusting the Thread Tensioning

The SL Router Lift features our patented thread-tensioning design, which holds the router in position when you set the cutting height. Thread tension is set at the factory, and depending on the amount of use, you may have to reset this adjustment periodically. If the bit height ever begins to drop during use, the thread tensioning probably needs to be reset.

1. Turn the Lift upside down, with the threaded height adjustment rod facing you.
2. With a 7/16" open-end wrench, loosen the 1/4"-20 hex nut on the left side of the brass post next to the threaded rod. Then use a hex wrench to back out the set screw that threads through the nut until the brass tensioning collar can be turned. **Fig. 10.**
3. Rotate the brass tensioning collar (with vertical grooves) so it tightens against the rubber washer. **Fig. 11.** (If needed, a drop of oil on the rubber washer can ease the rotation of the brass collar.)
4. Tighten the brass collar, making certain that the set screw seats in one of the vertical grooves.
5. Tighten the 1/4"-20 nut with the 7/16" wrench. The adjustment is complete.



Fig. 11



Fig. 12

Using the Starter Pin

THESE WARNINGS PERTAIN TO THIS SECTION:

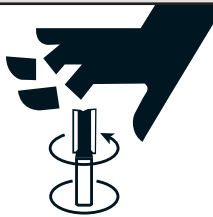

⚠ DANGER

- > To avoid serious injury, keep hands and fingers away from spinning router bit. Maintain awareness of the bit at all times.

⚠ WARNING

- > If attempting to rout a workpiece without using the router table fence, always use the included Starter Pin to begin the cut. Failure to do so could result in dangerous workpiece kickback and serious injury.
- > Use the Starter Pin **ONLY** with bearing-guided router bits. Use with other bits could result in serious injury.

Use of a Starter Pin is required when you're not using the fence on your router table to feed your workpiece into the bit. Stock is most vulnerable to catching and being thrown at the beginning of the cut, before it engages the router bit's guide bearing. Install the Starter Pin, which consists of a round-head bolt through a non-marring plastic sheath, into the mounting hole in the SL Router Lift plate. Then use the Starter Pin as a fulcrum to feed your workpiece into the bit. Be sure the pin is screwed in tightly before use. **Fig. 12.**

Check Rockler.com for updates. If you have further questions, please contact our Technical Support Department at 1-800-260-9663 or support@rockler.com